



THE BENYON ESTATE

De Beauvoir Road N1 4EL

£3200 per month



Recently refurbished beautiful garden maisonette with modern fixtures and fittings throughout, with a spacious open-plan kitchen and reception. This property offers two double sized bedrooms offering a bathroom and separate shower room. The private garden has been landscaped to a lovely finish with a fully maintained front garden. Private use of the driveway is also available.
rent collected by Direct Debit

The property is located on De Beauvoir Rd which is set within easy reach of the superb range of elite shops, bars and restaurants of Upper Street, Shoreditch and the city while providing motorists with quick and easy access to the A1 road links out of London and to the North. The nearest underground station is Highbury & Islington and Angel (Victoria Line and National Rail). plus Haggerston and Dalston Junction overground trains are very close by on the Kingsland Rd.

- Available now
- 2 Double Bedrooms
- 1 Bathroom
- 1 Shower room
- Open-plan kitchen and living space
- Private garden
- - Use of driveway

Interested? If you are interested in viewing this property or would like to register, please contact our team on **020 7249 3690**. Alternatively, email info@thebenyonestate.com.



THE BENYON ESTATE

De Beauvoir Road N1 4EL

£3200 per month

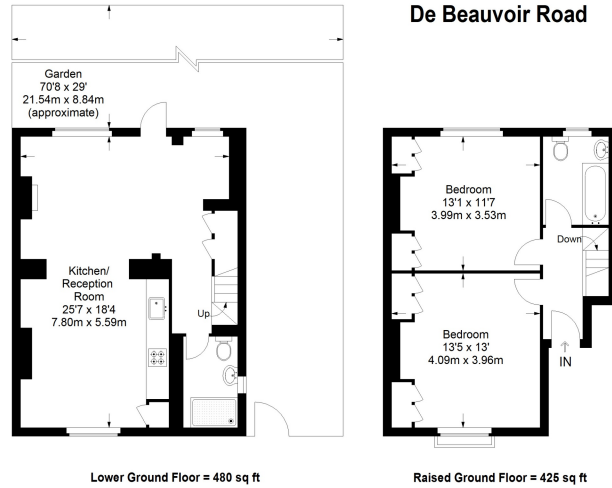

Approximate Gross Internal Area
LOWER GROUND FLOOR = 480 sq ft / 44.59 sq m
RAISED GROUND FLOOR = 425 sq ft / 39.48 sq m
Total = 905 sq ft / 84.07 sq m



This plan is for layout guidance only. Not drawn to scale unless stated. Windows and door openings are approximate. Whilst every care is taken in the preparation of this plan, please check all dimensions, shapes and compass bearings before making any decisions reliant upon them. (ID357409)

Interested? If you are interested in viewing this property or would like to register, please contact our team on **020 7249 3690**. Alternatively, email info@thebenyonestate.com.