



THE BENYON ESTATE

Ardleigh Road N1 4HS

£1850 per month



This fantastic spacious 1st floor flat is set within a period conversion and offers ample living space. The property is bright and airy with lots of natural light and modern fixtures and fittings throughout. The property is in very good decorative condition.

Whilst being very well located for transport links to Central London and the city, Ardleigh Road is ideally located close to local shops and amenities on Southgate Rd and Kingsland Rd. The property is also close to Islington's charming Upper St and Shoreditch, both areas offering a fantastic range of bars, restaurants, theatres and gig venues.

- DEPOSIT FREE OPTION AVAILABLE
- 2 Double sized bedrooms
- 1 Bathroom
- 1 Separate large reception room
- 1 Kitchen
- Unfurnished
- Available Now

Interested?

If you are interested in viewing this property or would like to register, please contact our team on **020 7249 3690**. Alternatively, email info@thebenyonestate.com.



THE BENYON ESTATE

Ardleigh Road N1 4HS

£1850 per month

First Floor

Approx. 64.0 sq. metres (688.7 sq. feet)

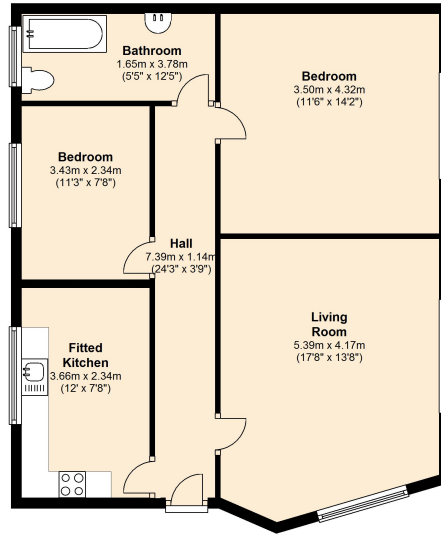

Total area: approx. 64.0 sq. metres (688.7 sq. feet)

Interested? If you are interested in viewing this property or would like to register, please contact our team on **020 7249 3690**. Alternatively, email info@thebenyonestate.com.